

TILLAMOOK COUNTY SURVEYORS OFFICE
COURT HOUSE, TILLAMOOK OREGON 97141

1/4 SECTION CORNER COMMON SECTIONS
22 & 23 T.4S., R.10W., W.M.



I FOUND A 2' U.S.F.S. ALUMINUM PIPE WITH A 3 1/2' ALUMINUM CAP, 24' BELOW THE SURFACE OF THE GROUND, SET ON TILLAMOOK COUNTY SURVEYORS MAP B-1189.

HISTORY OF FOUND MONUMENT

I FOUND THIS MONUMENT TO BE AS DESCRIBED ON T.C.S. MAP B-1189 AND THE REFERENCES SET AT THAT TIME TO NOW BE AS FOLLOWS:

(MAP B-1189) 23' MAPLE N.41°W. 53.6', REPORTED ON MAP B-1205 AS A 23' MAPLE AT THE SAME BEARING AND DISTANCE; (FOUND, NOW A ± 30' LOW CUT MAPLE STUMP, AT POSITION).

(MAP B-1189) 48' COTTONWOOD S.61°W. 64.7', REPORTED ON MAP B-1205 AS A 48' COTTONWOOD AT THE SAME BEARING AND DISTANCE; (FOUND, NOW A 48' COTTONWOOD STUMP, 4 FEET HIGH, ROTTED FACE, U.S.F.S. YELLOW METAL LOCATION POSTER ATTACHED, AT POSITION).

NEW ACCESSORIES



I SET A 5/8" X 12" IRON ROD WITH 3" TILLAMOOK COUNTY SURVEYORS BRASS CAP, 4" DEEP, IN AN IRREGULAR MASS OF CONCRETE, DIRECTLY OVER THE FOUND U.S.F.S. MONUMENT. STAMPED AS SHOWN AT LEFT.

*I SET A 5/8" IRON ROD WITH A RED PLASTIC CAP INSCRIBED T.C. SURVEY IN THE CENTER OF A 48" DIAMETER 2' HIGH COTTONWOOD STUMP, N.44°58'05"W. 199.83'.

*72" LIGHT HAT SECTION POST EAST 1.5'.

* INDICATES TILLAMOOK COUNTY YELLOW METAL LOCATION POSTER ATTACHED.

SURVEYS AND REWITNESSES OF RECORD

B-1399	NOV. 1989	DOUGLAS KELLOW	LS 2027
B-1189	3-20-1985	EDGAR R. COOK	LS 1073
		& JAMES M. GRIFFIS	LS 1637
B-1205	SEPT. 1985	RONALD G. LARSON	LS 2102

MONUMENT LOCATION

THIS MONUMENT WAS VIRTUALLY UNDETECTABLE WITH A METAL DETECTOR, AND IS LOCATED IN A LARGE BLACKBERRY PATCH ± 125' NORTH OF THE NORTH BANK OF THE BIG NESTUCCA RIVER, AND ± 100' SOUTH OF A CLEARED PASTURE. THE WITNESS CORNER SET BY A.M. AUSTIN 12-1-1903, IN REWITNESS BOOK 4 AT PAGE 10, WAS NOT SEARCHED FOR. THIS IS A PROPORTION POINT. NO MEASUREMENTS WERE TAKEN TO CONFIRM ITS LOCATION WITHIN THE SECTION SUBDIVISION.

IN THE PRESENCE OF DAN MCNUTT AND AL DVORAK
MAY 27, 1998

TITLE:

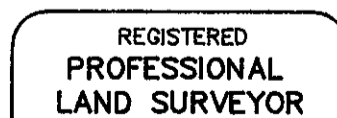
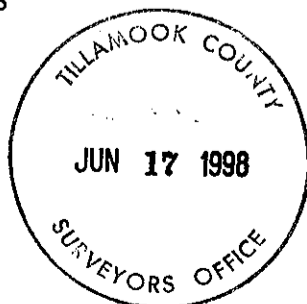

Allan E. Duncan, C.S.

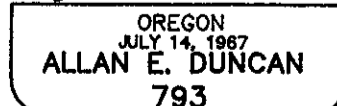

EXPIRES 12-31-99